

1 PLAN VIEW

ABOVE FLOOR CLOSER  
 MUST BE MOUNTED AT  
 +90°, OR -90°

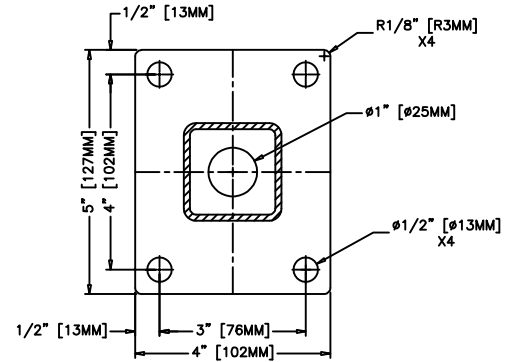

LATCH POST FLANGE DETAIL

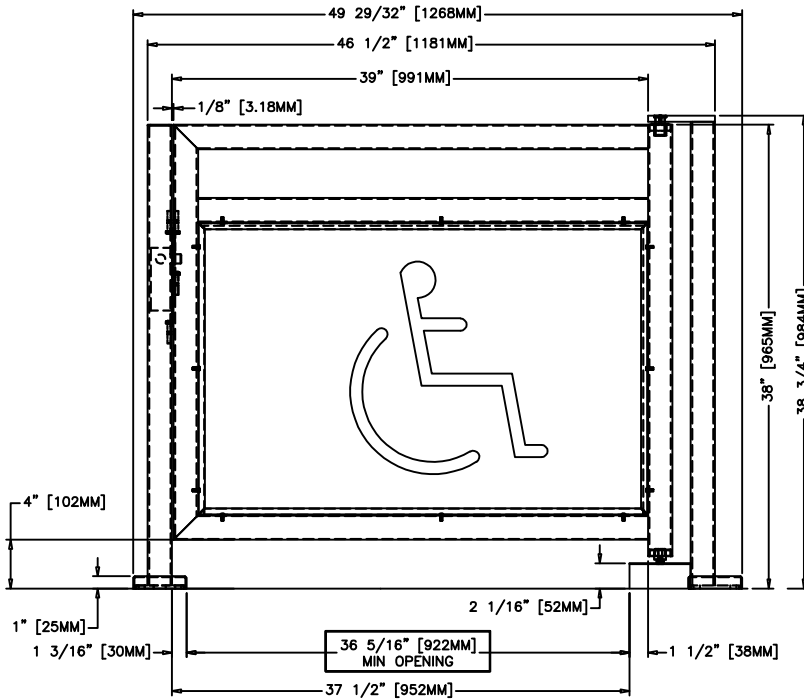

2 FRONT ELEVATION

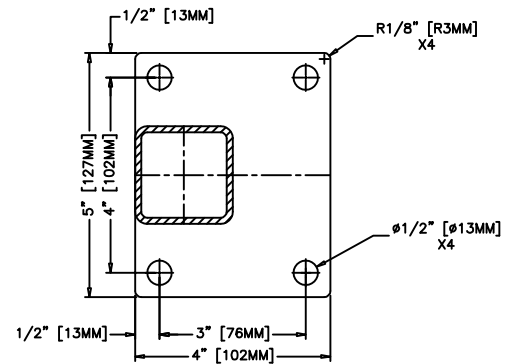

HINGE POST FLANGE DETAIL

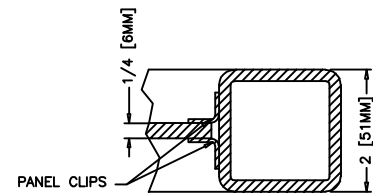

GLASS DETAIL

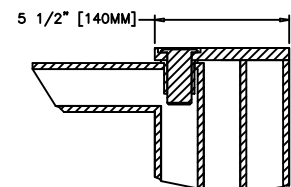

HINGE DETAIL

**OPTIONS:**

- ONE WAY (90°) LH OR RH SWING
- MATERIAL: #4 SATIN STAINLESS STEEL (STD), POWDER COATED STAINLESS STEEL (OPTIONAL)
- ABOVE FLOOR HYDRAULIC CLOSER (SHOWN), BELOW FLOOR (OPTIONAL)
- ELECTRIC LOCK-ELECTRIC DEADBOLT (SHOWN), MAGLOCK,  
OR ELECTRIC STRIKE + PANIC BAR (OPTIONAL)
- MECHANICAL LOCK-MECHANICAL DEADBOLT
- REMOTE PUSHBUTTON (OPTIONAL)
- POWER SUPPLY - 24VDC (OPTIONAL)

**INSTALLATION:**

- GATE INSTALLS ON FINISH FLOOR
- FLOOR MUST BE DEAD LEVEL
- GATE IS FREE-STANDING
- CLOSER UNIT MOUNTS ABOVE FLOOR (BELOW FLOOR CLOSER OPTIONAL)